



## Project Gallery

# Streets and houses of Roman Alexandria revisited

Grzegorz Majcherek\* 

\* Polish Centre of Mediterranean Archaeology, University of Warsaw, Poland

(✉ [g.majcherek@uw.edu.pl](mailto:g.majcherek@uw.edu.pl))

The residential architecture of Alexandria has traditionally been extrapolated based on comparison with the plans and decoration of monumental hypogea from the Ptolemaic and Roman periods. New evidence from an archaeological research programme launched at Kom el-Dikka offers novel insights into the style of domestic architecture and the urban topography of the city.

Keywords: Egypt, Alexandria, Roman, architecture, housing, urban layout

Alexandria, like other ancient cities, had a built-up area, in which regular housing must have comprised around 70–80 per cent of the urban area. Domestic architecture, however, remains on the margins of targeted archaeological research at Alexandria—lagging far behind work on temples, churches, other public buildings and cemeteries. The reason for this is as banal as it is obvious: with so few surviving archaeological examples available, very little research can be done. A breakthrough came with the Polish Centre of Mediterranean Archaeology, University of Warsaw’s archaeological project on Kom el-Dikka. Remnants of dwellings have been explored at this site since the 1990s, but it is only recently that the investigation gained new momentum. In 2017, a new phase of the project was launched, focusing on two closely related issues: the residential architecture and the street network.

As many as ten of the approximately 13 Roman houses known so far from Alexandria were uncovered at Kom el-Dikka (Tkaczow 1993; Majcherek 2007) (Figure 1). These buildings, constructed predominantly in the first and second centuries AD, provided the much needed archaeological evidence to address a key research focus: analysis of the layout, internal decoration and functional design of these houses, in an attempt to define a ‘standard’ Alexandrian Roman *domus* (house), and to situate this evidence within its wider Mediterranean context.

An obvious link between houses, city blocks and, by extension, the street network emerges repeatedly in our research. Although the basic street grid identified in the nineteenth century by Mahmud Bey el-Falaki (1872) is generally accepted and—despite some reservations—remains the fundamental system of urban morphology, later attempts at calculating the size of the city blocks using dimensions of a basic house lot produced somewhat equivocal results (e.g. Rodziewicz 1984: 45–48).

The huge quarters (278 × 310m) delineated by wide streets were certainly too big to sustain proper urban functionality without additional access points between buildings. Internal

---

Received: 26 December 2019; Revised: 31 March 2020; Accepted: 1 May 2020

© The Author(s), 2021. Published by Cambridge University Press on behalf of Antiquity Publications Ltd. This is an Open Access article, distributed under the terms of the Creative Commons Attribution licence (<http://creativecommons.org/licenses/by/4.0/>), which permits unrestricted re-use, distribution, and reproduction in any medium, provided the original work is properly cited.



Figure 1. Extant walls of an early Roman house excavated in the 2019 season (photograph by G. Majcherek).

communication necessitates the existence of secondary streets that separate individual city blocks (Adriani 1966). Our excavations at Kom el-Dikka have traced several sections of such streets (Figure 2).

According to a hypothesis introduced by Wolfram Höpfner (1990), based largely on parallels from other Hellenistic cities, large *insulae* (city blocks) were divided into smaller blocks by two narrow latitudinal streets and five longitudinal streets. These produced areas containing six square house-lots, each covering approximately  $22 \times 22$ m. Our excavations at Kom el-Dikka, however, revealed the distance between the narrower ‘secondary’ streets to be approximately 52–53m; if their disposition is regular and symmetrical, as expected, then a simple calculation proves that each of Falaki’s (1872) basic *insulae* must have been split by four parallel streets, and not the two proposed by Höpfner (1990).

It has often been assumed that the orthogonal Hippodamian grid was the standardised plan for the entire city (e.g. Rodziewicz 1987). Data obtained from excavation in the north-western part of Kom el-Dikka, however, offer a slightly different view. While the orthogonal grid at Kom el-Dikka is oriented north-west to south-east, a small section of a street uncovered there follows a north–south orientation, which departs from the orthogonal model identified by Falaki (Figure 2). Although the street-grid issue is not yet fully resolved, another aspect of our research—the layout of the houses—is far better documented, even at this stage of the project.

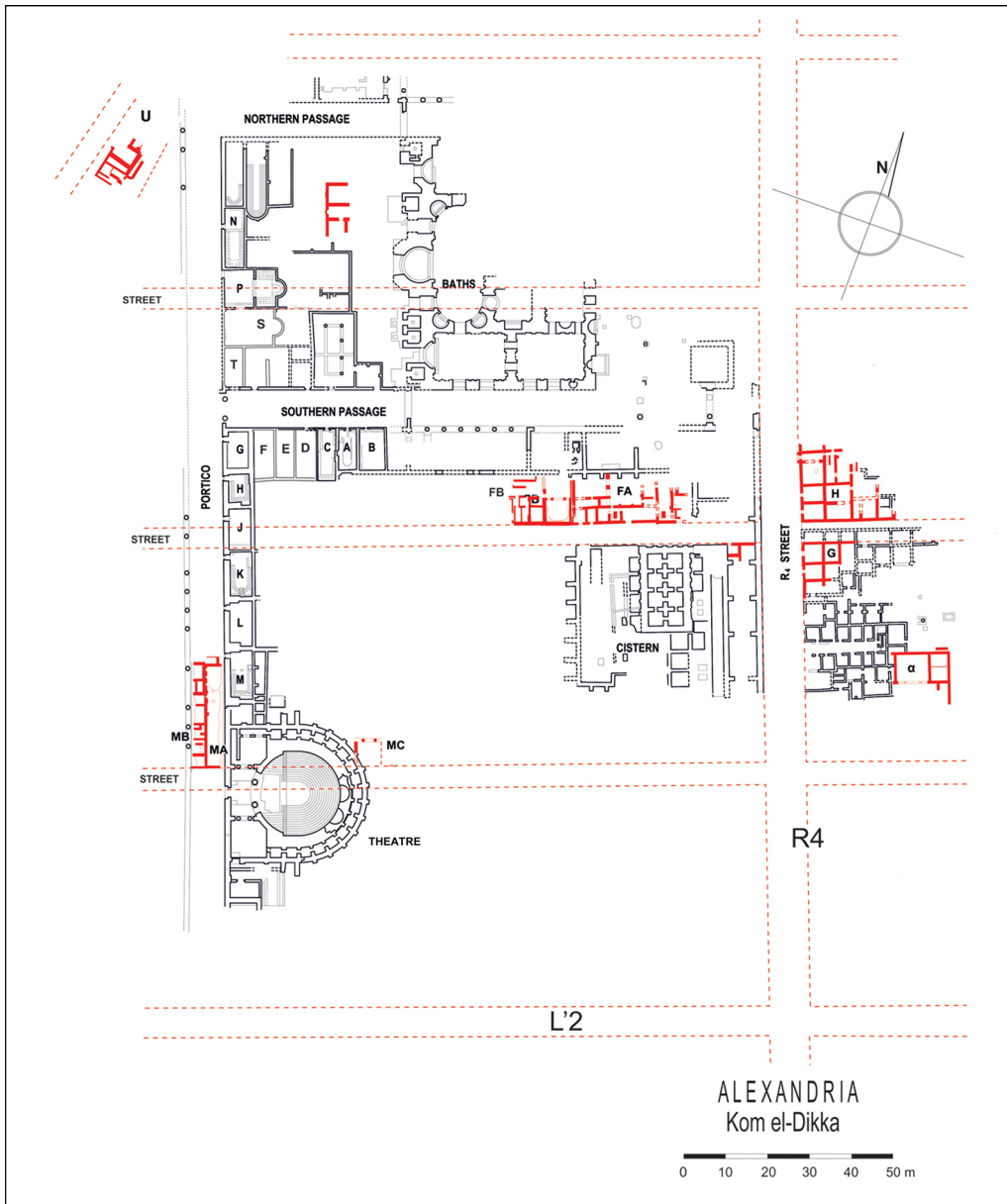

Figure 2. Plan of Kom el-Dikka site; the early Roman structures and streets are outlined in red (drawing by W. Kolataj, D. Tarana & G. Majcherek).

The excavated houses were designed on a rectangular plan, in two rows (back-to-back), each entered from a respective side street through a *prothyron*—a stepped porch—a common feature in local architecture, and known from Roman Fayoum (Figure 3). A key element of the layout was invariably the central courtyard (Figure 4). In terms of architectural decoration, the dominant design is a pseudo-peristyle, with engaged columns featuring plain shafts



Figure 3. Stepped entrance to one of the houses (photograph by G. Majcherek).

topped with Doric capitals (Figure 5). *Triclinia*—dining rooms—were revealed in all of the houses. These were usually entered through tripartite doorways, accentuated by columns, leading directly from the central courtyard. Their floors were decorated with mosaics, ranging from simple bichrome geometric designs to the more complex patterns that combine geometric elements with figural motifs, complete with colourful *emblemata* (central panels that were often highly decorative and finely worked) (Figure 6) (Majcherek 2002). Notably, all of these floor mosaics post-date the period of construction of the houses, which was established from stratigraphic archaeological evidence, and may possibly be associated with Alexandria’s alleged revival in the second century AD.

In contrast to the mosaics’ decorative motifs, which were drawn from a common iconographic vocabulary of the Classical Mediterranean world, the architectural decoration of the

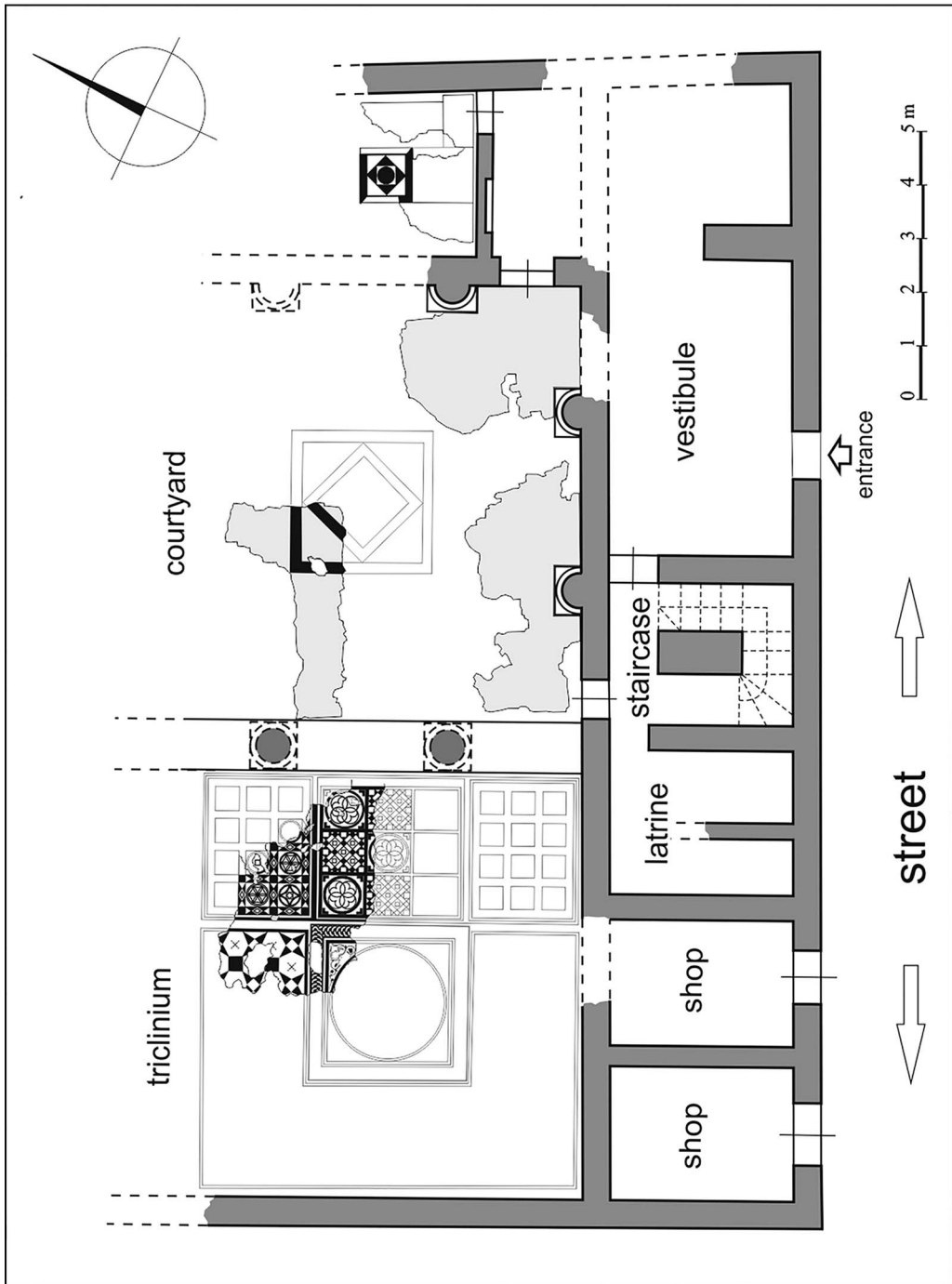

Figure 4. Plan of an early Roman house uncovered in the central area of the site (drawing by G. Majcherek & Z. Solarewicz).



Figure 5. A pseudo-peristyle courtyard (photograph by G. Majcherek).

houses at Kom el-Dikka appears to be almost exclusively typical of Alexandria. There is an entire range of distinctive cornices with square modillions and capitals, representing the so-called Alexandrian style. Samples of painted wall plaster collected from some of the houses resemble the First Pompeian ('structural') style, with the high monochrome socles and stuccowork, imitating *opus isodomum* (uniformly sized stonework). Similar decoration is known from the second-century BC tombs in the Anfushy and Mustapha Pasha necropolises (Adriani 1952: 47–128). The examples from Kom el-Dikka of apparently later date (mostly first century AD) demonstrate the continuity of the Hellenistic painting tradition in Alexandria over several centuries.

This research on the houses at Kom el-Dikka challenges a commonly accepted view—based predominantly on comparative analyses of extant sepulchral monuments—that the Alexandrian house design was derived from the peristyle model, which had replaced older designs in the second century BC (Adriani 1966: 201–209). It now appears that this building tradition drew on both the Greek peristyle and the *oikos* (the main governing room) house-planning models, while adapting specific elements to suit local needs, and thus confounding attempts to identify a uniform classification. Alexandrian houses at Kom el-Dikka clearly constitute a separate local type that brings together the *prosta-oikos* (porchway-main room) design and a pseudo-peristyle courtyard. Whether this was intentional design, or simply a practical compromise forced by the small size of urban plots in the city centre, we will



*Figure 6. A multicoloured mosaic decorating one of the triclinia (photograph by G. Majcherek).*

probably never know. It is hardly surprising that Roman Alexandria's houses draw on a common Graeco-Roman building tradition, but their undeniable allegiance to the Mediterranean world belies the inclusion of indigenous Egyptian elements.

### **Acknowledgements**

I would like to express my sincere gratitude to all colleagues involved in the research. Special thanks go to all the authorities of the Egyptian Ministry of Antiquities in Cairo, as well as in Alexandria for their generous help and support of our work.

### **Funding statement**

Our research is financed by the Polish Centre of Mediterranean Archaeology, University of Warsaw as part of the long-term multidisciplinary 'Archaeological and Preservation Project at Kom el-Dikka'.

## References

- ADRIANI, A. 1952. *Annuaire du Musée Gréco-Romain III (1940–1950)*. Alexandria: Imprimerie de la Société de publications égyptiennes S.A.E.
- 1966. *Repertorio d'arte del Egitto Greco-Romano, serie C, volume I*. Palermo: Fondazione 'Ignazio Mormino' del Banco di Sicilia.
- EL-FALAKI, M.B. 1872. *Mémoires sur le antique Alexandrie*. Copenhagen: F.S. Muhle.
- HÖPFNER, W. 1990. Von Alexandria über Pergamon nach Nikopolis: Stadtebau und Stadtbilder Hellenistischer Zeit, in *Akten Des XIII Internationalen Kongress für Klassische Archäologie, Berlin 1988*: 276–85. Mainz: P. von Zabern.
- MAJCHEREK, G. 2002. Mosaic floors from Roman triclinia in Alexandria, in Z. Hawwas (ed.) *Egyptology at the dawn of the twenty-first century: proceedings of the Eighth International Congress of Egyptologists, Cairo 2001*: 319–27. Cairo: The American University in Cairo Press.
- 2007. Houses of Alexandria: some aspects of architectural development in the Roman period, in K. Galor & T. Waliszewski (ed.) *From Antioch to Alexandria: recent studies in domestic architecture*: 201–11. Warsaw: Institute of Archaeology, University of Warsaw.
- RODZIEWICZ, M. 1984. *Alexandrie III. Les habitations romaines tardives d'Alexandrie à la lumière des fouilles polonaises à Kôm el-Dikka*. Warsaw: PWN—Éditions scientifiques de Pologne.
- 1987. Le débat sur la topographie de la ville antique. *Revue de l'Occident musulman et de la Méditerranée* 46: 38–48.  
<https://doi.org/10.3406/remmm.1987.2186>
- TKACZOW, B. 1993. *The topography of ancient Alexandria*. Warsaw: PWN—Éditions scientifiques de Pologne.